

# ARGONAUT

## SINGLE CONTROL LAVATORY FAUCETS

Model #:  
AG202-1, AG204-1



### BEFORE YOU BEGIN YOUR INSTALLATION:

1



Turn off water supply.

2



Observe all local  
plumbing codes.

3



Inspect plumbing for signs of  
damage. Replace as necessary.

4



**DO NOT** use petroleum based  
products on this faucet.

### REQUIRED TOOLS AND MATERIALS:

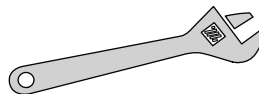

ADJUSTABLE WRENCH

**WARNING:** Cancer and reproductive harm - see [www.P65Warnings.ca.gov](http://www.P65Warnings.ca.gov)

### IMPORTANT!

- Read these instructions and plan the installation before beginning.
- Risk of product damage. Do not apply direct heat to the valve. Excessive heat will damage the plastic components and plaster guard.
- A mixed water supply is required for this product.
- Component location, spacing, and situational requirements can vary.

1.

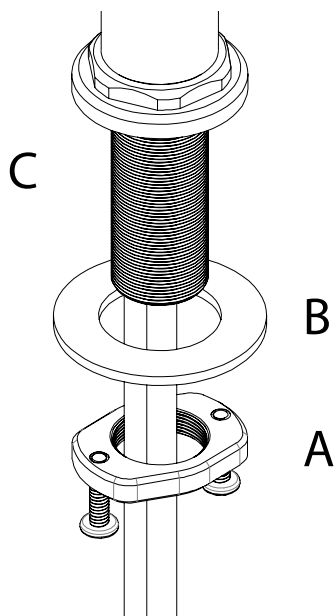

Remove the clamp nut (A) and washer (B) from the threaded shroud (C).

2.

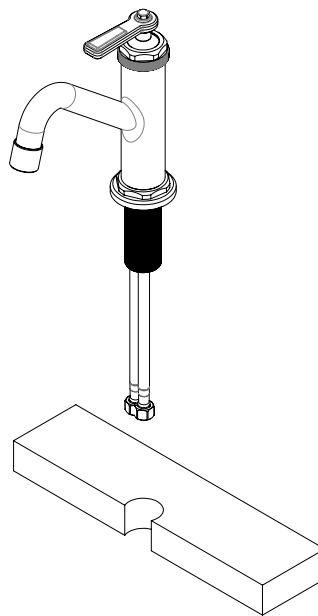

Fit flexible hoses (D) through hole on counter or sink. (No plumbers putty is required. O-ring seals base).

3.

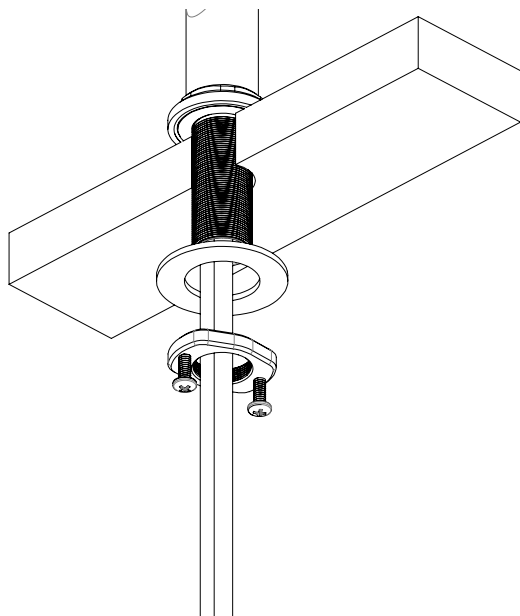

Slide washer and thread the clamp nut onto threaded shroud. Tighten nut snug to underside of sink or counter.

4.

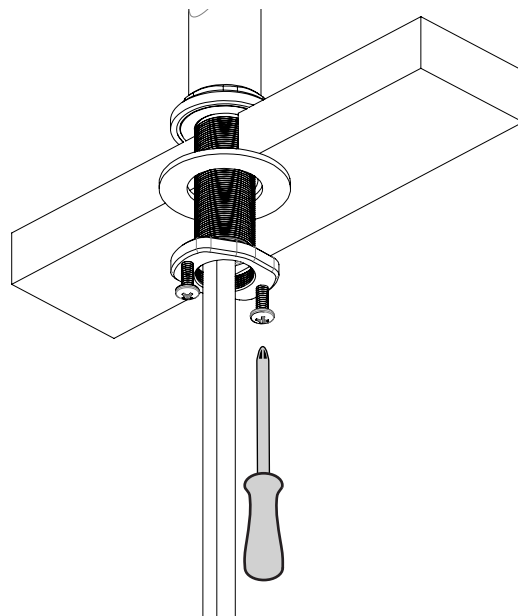

Turn faucet to the desired handle position. Securely tighten clamp screws (E).